

**Record of Map Amendments  
 South Interlake Planning District By-laws  
 Amending the South Interlake Planning District Development Plan  
 (Adopting B/L No. 3/10)  
 Map 15 – Gunton Settlement Centre**

MAP REF. #	BY-LAW NO.	COMMENTS
(1)	2/17	Replaced Map 15
(2)		
(3)		
(4)		
(5)		
(6)		
(7)		
(8)		
(9)		
(10)		
(11)		
(12)		
(13)		
(14)		
(15)		
(16)		
(17)		
(18)		
(19)		
(20)		
(21)		
(22)		
(23)		
(24)		
(25)		
(26)		
(27)		
(28)		
(29)		
(30)		
(31)		
(32)		
(33)		
(34)		
(35)		
(36)		
(37)		
(38)		
(39)		
(40)		

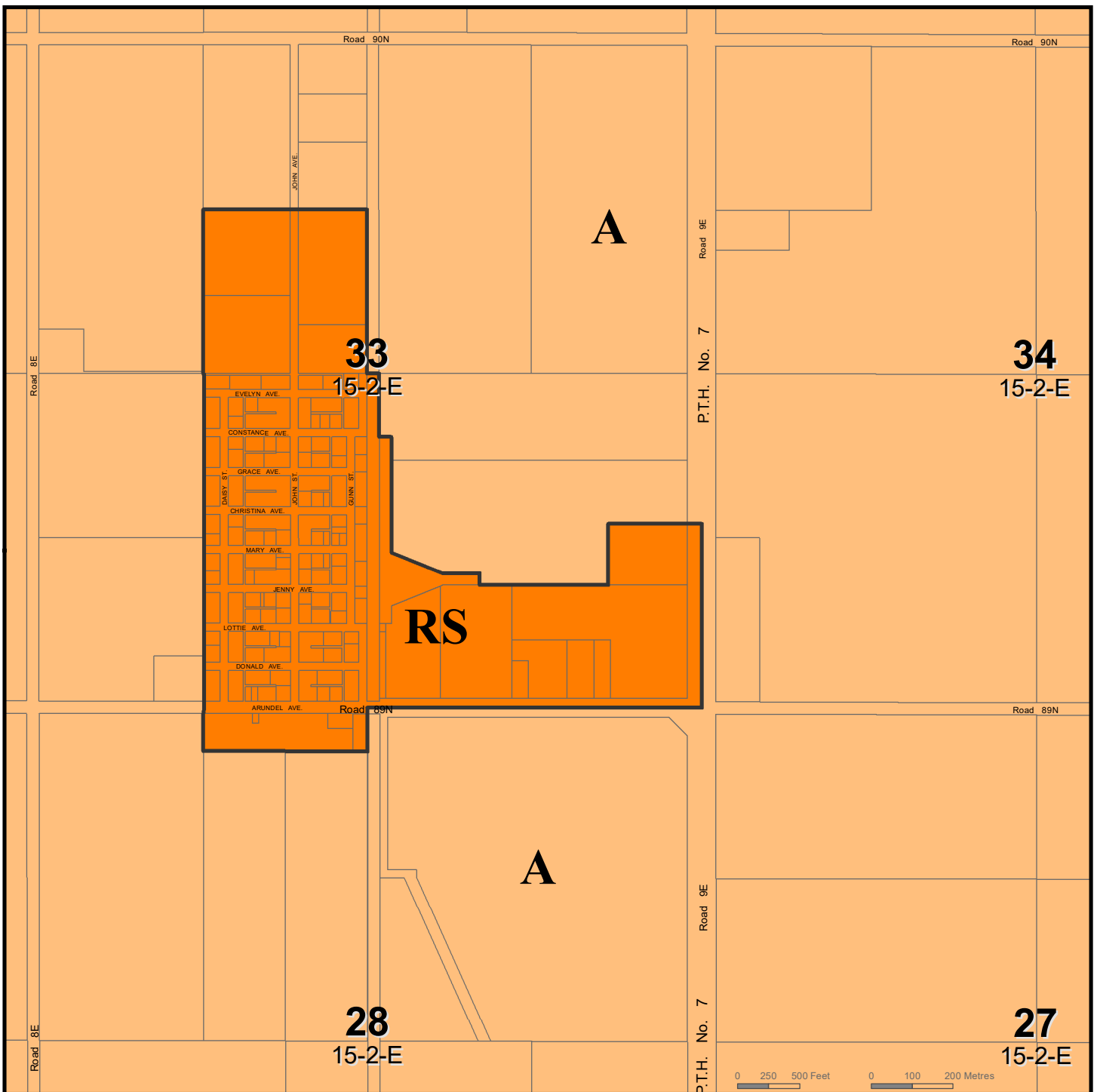

SOUTH INTERLAKE PLANNING DISTRICT DEVELOPMENT PLAN

**MAP 15**

**LAND USE CLASSIFICATION**

**Gunton**

OFFICE CONSOLIDATION  
UP TO AND INCLUDING  
BY-LAW No. 2/17  
July 29, 2019

Legend:

- A** Agricultural Rural Area
- RS** Rural Settlement Centre