

**Record of Map Amendments
 South Interlake Planning District By-laws
 Amending the South Interlake Planning District Development Plan
 (Adopting B/L No. 3/10)
 Map 14 – Balmoral Settlement Centre**

MAP REF. #	BY-LAW NO.	COMMENTS
(1)	2/17	Replaced Map 14
(2)		
(3)		
(4)		
(5)		
(6)		
(7)		
(8)		
(9)		
(10)		
(11)		
(12)		
(13)		
(14)		
(15)		
(16)		
(17)		
(18)		
(19)		
(20)		
(21)		
(22)		
(23)		
(24)		
(25)		
(26)		
(27)		
(28)		
(29)		
(30)		
(31)		
(32)		
(33)		
(34)		
(35)		
(36)		
(37)		
(38)		
(39)		
(40)		

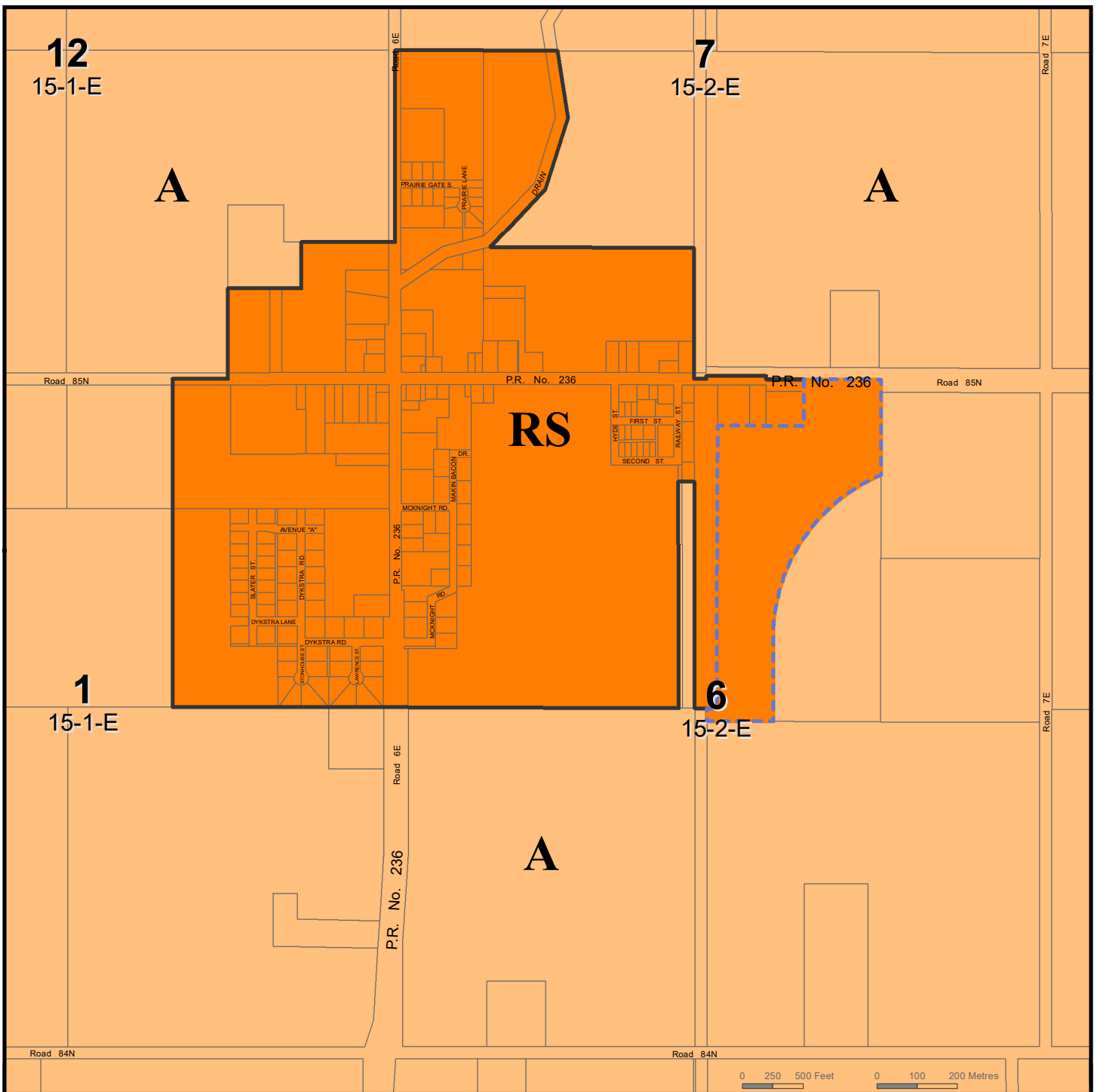

SOUTH INTERLAKE PLANNING DISTRICT DEVELOPMENT PLAN

MAP 14

LAND USE CLASSIFICATION

Balmoral

Legend:

OFFICE CONSOLIDATION
UP TO AND INCLUDING
BY-LAW No. 2/17
July 29, 2019

- A** Agricultural Rural Area
- RS** Rural Settlement Centre
- Development shall be limited to non-residential